



# DL Cabinetry - Layout Checklist

Project Address: \_\_\_\_\_  
 \_\_\_\_\_  
 Email: \_\_\_\_\_  
 Phone Number: \_\_\_\_\_

Date: \_\_\_\_\_

- Select Cabinet Line**  
White Shaker (WS)  
Dove Grey (DG)  
Pearl White (PW)  
Glacier White (GW)  
Flex Shaker (FS)  
Dark Caramel (DC)  
Espresso Shaker (ES)

Company/Customer Name: \_\_\_\_\_

**New Design:**

**Edit Existing:**

**Room Shape:** No Room Shape Choice Applies: \*See Attached Photos\*

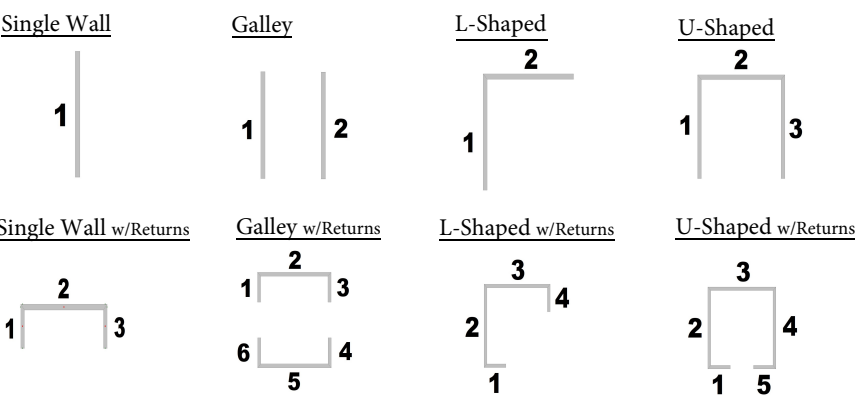

**Island:**

**Yes**    **No**    **Island Size(In)**  
 \_\_\_\_\_  
**Notes on Island:** \_\_\_\_\_

	<u>Length (In)</u>	<u>Height (In)</u>
Wall 1:	_____	_____
Wall 2:	_____	_____
Wall 3:	_____	_____
Wall 4:	_____	_____
Wall 5:	_____	_____
Wall 6:	_____	_____

**Wall Cabinet Height**

- 30" Wall Cabinets
- 36" Wall Cabinets
- 42" Wall Cabinets

**Sink**

- Undermount
- Farm / Apron

Size(In): \_\_\_\_\_

**Appliances**

	<u>Size (In)</u>	<u>Additional Notes</u>
Refrigerator	_____	_____
Dish Washer	_____	_____
Stove	_____	_____
Cooktop	_____	_____
Microwave	_____	_____
Range Hood	_____	_____
Clothes Washer	_____	_____
Clothes Dryer	_____	_____
Misc.	_____	_____

**Windows**

<u>Width (In)</u>	<u>Wall #</u>	<u>Window Location Distance from side (In)</u>
_____	_____	_____
_____	_____	_____
_____	_____	_____
_____	_____	_____

**Specialties:**

- Pantries
- Waste Basket
- Built In Fridge
- Drawer Bases
- Glass Doors
- Crown Molding
- Spice Rack
- Pullout Tray
- Other: \_\_\_\_\_

**Notes:** \_\_\_\_\_

# Measurement Guide

## Before You Start

- Record all measurements in inches (do not round)
- Make sure that all recorded measurements are clearly legible
- Assign one person to determine and record all measurements

## Record Ceiling Heights & Wall Lengths

- Draw an outline of the room
- Record the ceiling height on your outline
  - Measuring from the floor to the ceiling or base of the soffit
- Record the wall lengths on your outline
  - Start in one corner of your project area and measure to an adjacent wall
  - Continue around the room until all necessary walls have been measured

## Measure Windows

- Include all window trim as part of the measurements for windows
- Measure and record each window's width, height, and the distance from the window to the floor on the outline
- Add window locations to your outline
  - Start at the corner of any wall that contains a window and measure to the outside trim or edge of the window
  - Continue around the room until all necessary windows have been added to your layout

## Measure Appliances

- Measure or research and record the width, height, and depth of your sink and all appliances
- Add the sink location to your outline
  - Start at the corner of the sink wall and measure to the center of your sink
- Add the appliance locations to your outline
  - Notate the location of your dishwasher in relation to your sink (left or right) if applicable
  - Start at the corner of the range wall and measure to the edge of your range
  - Start at the corner of the refrigerator wall and measure to the edge of your refrigerator

## Room Outline Example

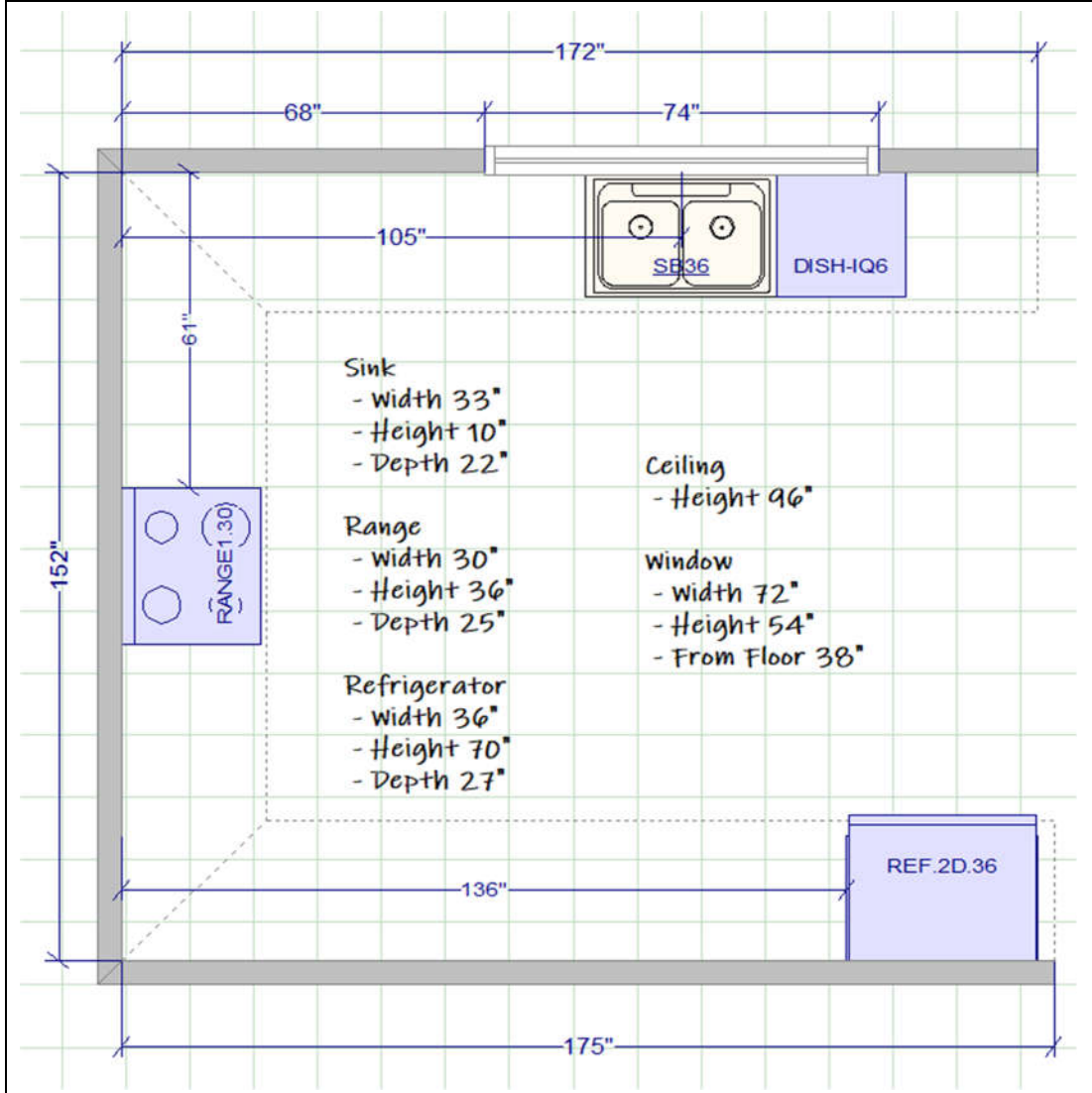

Unparalleled Quality. Unrivaled Convenience. Unbeatable Prices.